

Amtico Floor Maintenance

This card gives information for routine maintenance of Amtico Floors. For further information, please refer to our website www.amtico.com or ask your maintenance product supplier.

Before commencing work, put out signs to warn people that cleaning is in progress.

STEP 1 Daily Sweeping and dust mopping

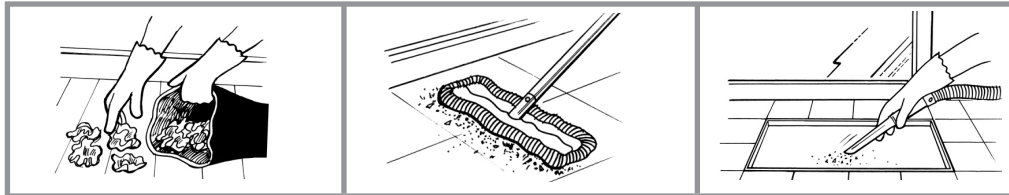

- Pick Up Litter and thoroughly sweep floor area using non-treated dust mop.
- Pick up debris with dustpan and brush or vacuum.
- Vacuum walk off mats and crevices at entrance.

STEP 2 Option 1 - Manual Maintenance

(Note: In conditions of heavy soiling, perform a pre-wash by preparing a solution of a neutral detergent diluted in accordance with the manufacturer's instructions and pre-wash heavily soiled areas)

Prepare a solution of neutral detergent diluted in accordance with manufacturer's instructions.

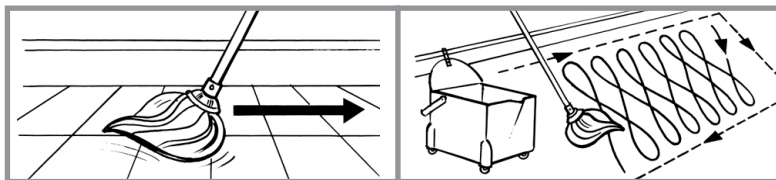

- Using a two-bucket mopping system, apply a solution using a well-wrung mop to remove soil.
- Mop using overlapping strokes.
- Rinse the mop frequently and change the solution as necessary.
- Allow entire floor area to dry thoroughly.
- Remove 'caution' signs.

Ensure all equipment is cleaned thoroughly after use and stored safely

STEP 2 Option 2 - Machine Maintenance

- Follow "Step 1" instructions, then:
- Prepare solution of neutral cleaner as per manufacturer's instructions. Use this solution for either (A) or (B) below.
- **A.** If normal maintenance incorporates the use of a scrubber/dryer, then the machine should be fitted with blue or green 3M nylon scrubbing pad. If a scrubber/dryer is not used, please skip to (B) below. Rotary washing machines may be considered for smaller areas.

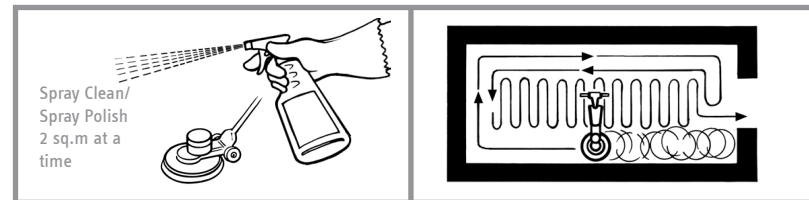

- **B.** Spray buffing may also be used to maintain the surface appearance.
- Pour neutral cleaning solution in to a suitable spray container.
- Apply a fine mist of liquid on to an area of approximately 2 square Metres at a time. Use a rotary buffing machine (approx. 450 rpm) fitted with a blue or green 3M nylon scrubbing pad.
- Work in parallel overlapping passes until the floor is clean and barely dry.
- Do not continue passes after the floor has dried.
- Remove "Caution" signs.

Ensure all equipment is cleaned thoroughly after use and stored safely

Note: Amtico Super-tough finish does not require dressing and should not be buffed with any pad more abrasive than a 3M red pad. For further information on chemical and machinery selection, please see "The Amtico Guide to Maintenance Products".

Tips - Dealing with Spills

- Spills of water, grease, food, chemicals and other foreign matter may cause the floor to become slippery.
- Wipe up spills immediately with an absorbent cloth, then wash thoroughly with a properly diluted neutral detergent until the spill area is completely clean.
- Rinse and allow to dry thoroughly.

Periodic Maintenance

- At least once a year the floor should be scrubbed thoroughly to remove in-grained dirt and floor dressing if applied. Please refer to the Amtico guide to stripping a floor.

Guide to Stripping an Amtico Floor

This card gives information for stripping a floor to remove in-grained soiling and floor dressing if applied.

Before commencing work, put out signs to warn people that cleaning is in progress.

STEP 1 Preparing the Solution

Prepare a solution of floor dressing remover as per manufacturer's instructions. Carefully follow all safety instructions, particularly noting that the floor can become slippery during the stripping process.

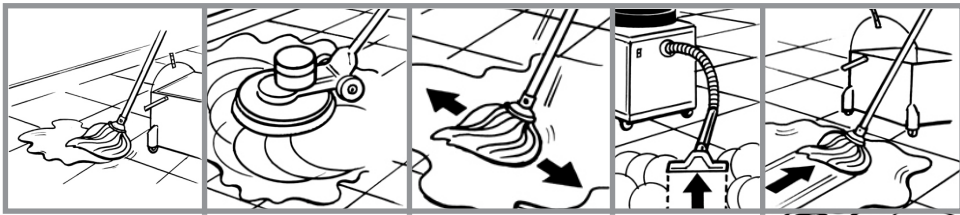

- Apply plenty of solution over a manageable area.
- Allow 5 - 10 minutes contact time.
- Either machine scrub with a Green 3M pad or agitate solution with mop. Do not allow slurry to dry.
- Either remove slurry with wet vacuum machine or mop and bucket. Rinse floor twice with clean water, allow to dry.

STEP 2 Application of Dressing (If Required)

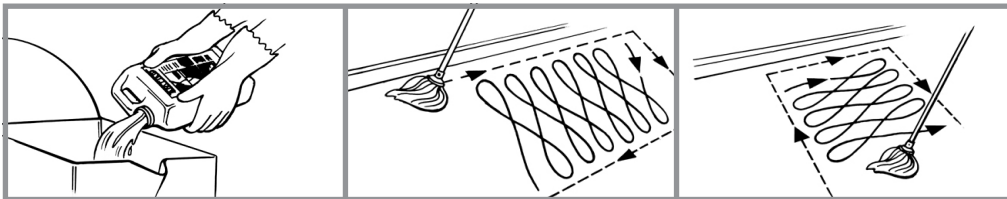

- Pour quantity of polish into bucket.
- Load mop with polish.
- Apply thin even coat.
- Start at furthest point from exit.
- Apply a thin even coat 15-25cm from the skirting and fill in with overlapping passes. Allow to dry (approx 30 mins).
- Apply a second coat at 90° to first.
- Allow to dry (approx. 30 mins). Do not buff for 24 hours.

NOTES:

Remove "Cleaning in Progress" signs

All equipment should be cleaned thoroughly after use and stored safely.

Do not use the same equipment for stripping as that used for application of floor dressing.

Amtico Super-tough finish does not require dressing (other than in a heavily trafficked area) and should not be buffed with any pad more abrasive than a 3M red pad.

Entrance mats, when properly serviced, can effectively remove any abrasive and foreign materials from foot traffic and cut down on tracked in water. The Amtico Company recommends a minimum of two full strides of entrance matting.

For further information, refer to "The Amtico Guide to Maintenance Products" or ask your maintenance product supplier.